

INSTALLATION & OPERATING MANUAL

DDL500 Direct Flow

Reverse Osmosis System

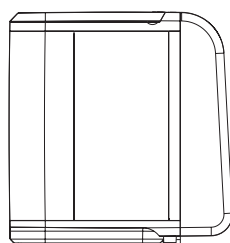
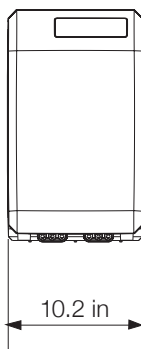
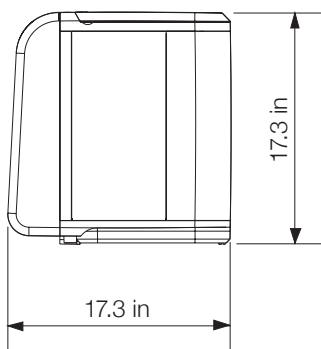

DDL500



INCLUDED IN THE BOX:



G500 Reverse Osmosis System

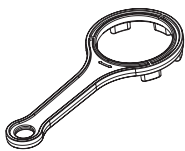

Wrench

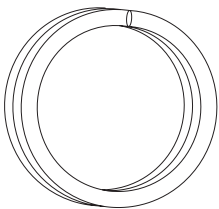

Blue, white and black tubes

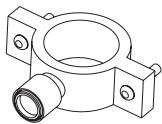

Waste water clip

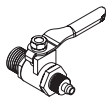

Brass ball valve

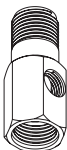

Water adaptor

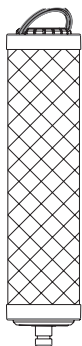

Carbon filter

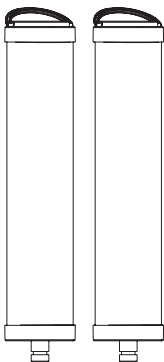

PP filter



Reverse osmosis membrane

PRODUCT CHARACTERISTIC & SPECIFICATION

- Compact and sleek design for under-counter kitchen use
- Water inlet off-switch for easy filter replacement
- Clear housing cover with upward filter housing design for easy filter replacement
- Rejection rate of 1:2 with a production rate of 400 gallons per day (GPD)
- Direct water purification without water storage - every drop is fresh tasting water
- 100% Made in Taiwan

Specification Number		G500
Model Code		SA0001
Main body	Dimensions	17.3 x 10.2 x 17.3in 44 x 26 x 44cm
	Weight	42lb 19kg
Maximum tube size		3/8"
Operating Pressure		20 - 60 psi 1.4 - 4.1 bar
Maximum Pump Pressure		125 psi 8.6 bar
Power Input		110V 60Hz / 230V 50Hz/60Hz
Power Consumption		36V DC/2A
Recommended Water Temperature		41°F - 100°F 5 - 38°C
RO Filter	Purification Rate	1L/min / ¼ gpm
	Substances Eliminated	Sediment Material, Heavy Metals, Pesticides, Chemical Substances.

PRODUCT ANNOUNCEMENT & WARNING:

This manual is to illustrate the G500 Direct Flow RO water purifier installation and operation instructions. Please be sure to read the contents of this manual. This product is designed exclusively for household water systems.

Compliance with local regulations: The system should be installed by a qualified professional installer or licensed mechanic.

The G500 High Flow RO water purifier comes with high-tech filtration technology; its RO membrane can filter out common harmful pollutants. The product can automatically filter out volatile organic chemicals, chlorine, odor, color, sediment, and suspended impurities in household water.

Precautions Before Installation:

- Please install the system for use with tap water. It should not be installed in other water sources, such as mountain spring water or ground water.
- Filters must be installed according to labeling and with the designated inlet water flow direction. The inlet water temperature should not be over 100°F | 38°C.
- System is only suitable for the cold water piping line. Do not use on hot water piping.
- Water pressure must not exceed 60 psi. Minimum water pressure should not be lower than 20 psi.
- Avoid ambient temperatures over 100°F | 38°C.
- Avoid direct exposure to sun light.
- Pay attention to safety when drilling close to the wires or plumbing parts of the installation.
- Filter compartment should not be impacted by other objects.

Warning

1. The warranty does not cover damage caused by consumer installation.
2. Do not set up or use the system in an unenclosed area.
3. System warranty does not cover damage caused by natural disaster.

DDL500 INSTALLATION AND DIAGRAM:

Faucet & Parts Installation Diagram

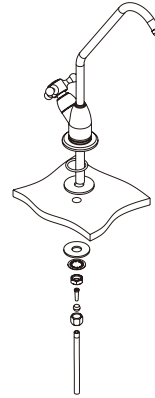

G500 Installation

1. Install the system in a cabinet.
2. Connect white tube to the bottom back of the G500 outlet quick connector.
3. Install the faucet.
4. Connect the other end of white tube to the faucet.
5. Connect water source to the water adapter and brass ball valve with blue tube.
6. Connect the other end of the blue tube to the bottom back of G500 System water inlet quick connector.
7. Connect black tube to the bottom back of G500 waste quick connector, then connect the other end of the tube to drain using wastewater clip.
8. Plug in power cord and begin initial water purification run - do not drink the initial run water.
 - a. Make sure that "Power On" light is lit up.
 - b. Open faucet and wait for water to come out (this can take up to 15 seconds).
 - c. Leave the faucet on, turn off power by unplugging the power cord (repeat this process three to four times).
 - d. Connect the power cord again, "Auto Flush" light will be blink, indicating that auto flush is performed, this will last for 2 minutes.

DDL500 INSTALLATION:

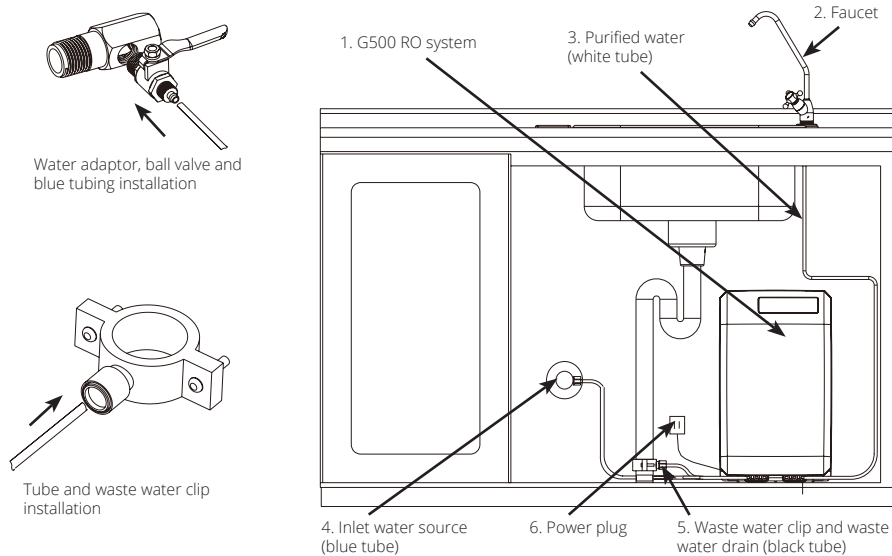

G500 System Indication Lights

- **AUTO-REL.:** Blinking light indicates that the system is performing auto flush.
 1. At initial power up, the system will auto flush for the 2 minutes.
 2. Auto flush will be performed everytime, 5 minute after the system is been used. Flushing lasts 15 second. After continuous use for over 30 minutes, system will auto flush for 30 seconds.
- **PUMP ON:** Blinking "PUMP ON" light indicates the system is generating water.
- **NO WATER-IN:** Blinking "NO WATER-IN" light indicates insufficient water entering into the system.
- **POWER:** Power indicator, in case this is not illuminated, please check if the power cord is plugged in.

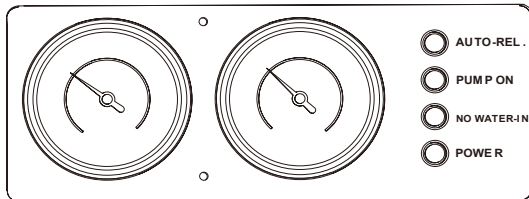

Pressure Gauges

- Left gauge indicates water inlet pressure
- Right gauge indicates water pump pressure

FILTER REPLACEMENT PROCEDURE:

First Installation/ Filter Replacement:

1. Turn off the water inlet switch or water source.
2. Open filter cover (direction indicated by wrench).
3. Filter should be placed according to the following instructions:
 - a. Filter compartment #1 : PP filter (white filter top cap)
 - b. Filter compartment #2: Carbon filter
 - c. Filter compartment #3 : PP filter (white filter top cap)
 - d. Filter compartment #4 : RO filter
4. Filter should be pushed firmly into the proper position mention above. (Caution: Filter pulling ring should face up, the filter O-ring should face downwards into the filter compartment.)
5. After installation or replacement of filter, use the spanner wrench to close and tighten the filter housing cover.
6. The system includes five filter cartridges, the fifth cartridge (post filter T33 carbon filter) is been installed inside of front housing compartment.
7. When replacing the filters, first release the water and air inside of the system by closing the water inlet. Open the faucet and drain out the water inside of the G500 system before opening the housing cover.

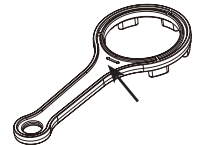
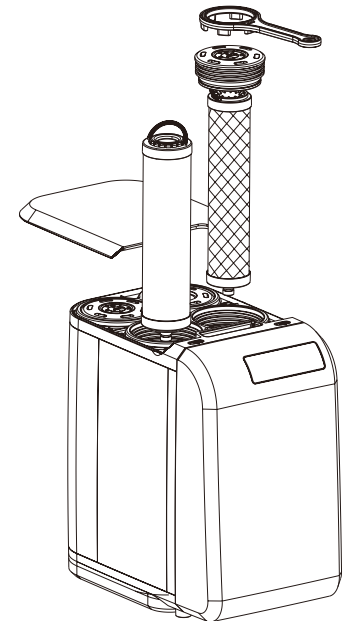
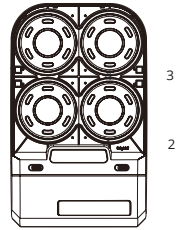

Wrench operation direction



AUTOCLAVE - WASHER - DISINFECTOR
SALES - REPAIR - SERVICE

Unit 6 Apollo Court, Whitehills Business
Park, Blackpool FY4 5FS
T: 01253 736355
www.dentaldecontamination.co.uk